

GRASSHOPPER®

# MAXIMIZERS™

For FrontMount™ Mowers

Maximize the performance of your Grasshopper!



Committed to the Cut.®



# TABLE OF CONTENTS

5	Engine Performance MAXimizers™
6	Power Unit MAXimizers™
8	Lever and Seat Kits
12	Deck MAXimizers™
16	Blade Chart
18	Mulching Packages
20	Implement MAXimizers™
23	PowerVac™ MAXimizers™
25	Tires & Steering: Traction & Turning
29	Tire Sealant
30	OEM Parts - Protecting Your Investment
31	Counterweight Requirements



# Engine Performance MAXimizers™

## 40-AMP ALTERNATOR KIT

For liquid-cooled Kubota engine. Recommended when installing two or more electrical options or when specifications require 40-amp alternator. Standard on 725DT, 729T, 900D 1.3L & 932.

DETAILS	ORDER #
721DT	604020
928D2 and 930D2	KU1145

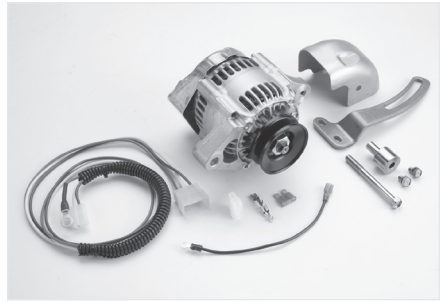

## BATTERY MINDER

Keeps batteries at full charge and prevents sulfation on battery plates through a patented pulsation process. Battery Minder can be connected to batteries in the cradle of power units. Backed by a 5-year warranty.



ORDER #

102050

## BLOCK HEATER

Block heater for Kubota liquid-cooled engines helps with cold-weather starting.

DETAILS	ORDER #
725DT, 729T & 932 with SN 5500000 and above	KU1174
928D2, 930D2 and 900D 1.3L	KU1176
932 with SN 5499999 and below	KU1176

## FILTER MINDER® KIT

Filter Minder® Kit signals when it is time to change the inner air filter element. Available only for models 725DT, 729T, 729BT and 735BT. (Standard on 900 Series.)



ORDER #

603326

## RADIATOR CLEANOUT TOOL

For liquid-cooled models. Attaches to standard garden hose and provides correct pressure and reach for thoroughly cleaning all four corners of the radiator cooling fins (without bending the fins) and all areas in between. A must-have if mowing in hot or dry conditions.

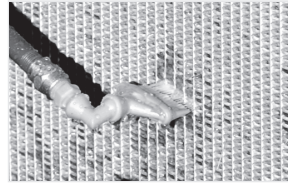

ORDER #

609015

## SWELL LATCH

For radiator grille on liquid-cooled models and sight windows on PowerVac™ Collection Systems.

ORDER #

604805



## TEMPERATURE SENTRY/CLUTCH CUT OFF

For liquid-cooled models (SN 6299999 **and below.**) Keeps tabs on the engine temperature gauge, automatically shutting off PTO in the rare event an overheat condition occurs. A safeguard in multi-operator environments or where mower will be used in dry, dusty conditions. **Contact dealer for order number.** (Standard on models with SN 6300000 **and above.**)

## TEMPERATURE SENSOR

Low Oil Audible Signal Kit for liquid-cooled models sounds an alarm if it detects low oil pressure or high engine temperature. Mounts on console filler panel above fender.

ORDER # 604025

# Power Unit MAXimizers™

## COUNTERWEIGHT KITS

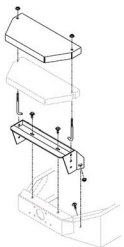

Required with many power unit and deck combinations and with many implements. Refer to the counterweight chart requirements located in your operator's manual.

DETAILS	ORDER #
50 lbs	503218
100 lbs	503219
Counterweight mount kit	503220

## CUP HOLDER KIT

Adjustable, locks into multiple positions to accommodate a variety of drink containers, including the larger “big gulp” sizes.

	ORDER #
	504185

## CUTTING HEIGHT CONTROL

Armrest Kit for mowers with PowerFold® provides fingertip control for cutting height adjustment from a convenient armrest position.

DETAILS	ORDER #
Armrest Kit	503068
For mounting to Premier Suspension (Gramer) Seat	503221

## DEBRIS SHIELD KITS

Recommended with Down Discharge™ mulching or rear-discharge mowing. Mounts underneath power unit frame to restrict uptake of clippings into engine and transmission areas of the power unit. Not recommended for 3552 rear discharge deck when mounted on 623T.

DETAILS	ORDER #
600 Series	504644
700 Series	504643
900 Series	504642

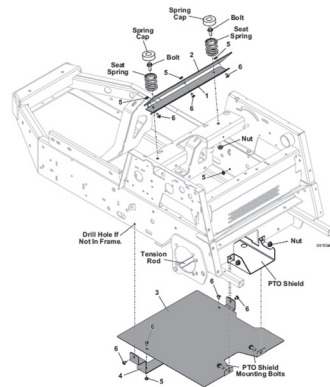

## FOLDABLE ROLL-OVER PROTECTION STRUCTURE (ROPS)

Allows units to be stored or transported into trailers with low clearance. If equipped with foldable ROPS, always wear seat belt when ROPS is deployed in upright position as described in operator’s manual. When foldable ROPS must be down (e.g., when loading or unloading from an enclosed trailer), DO NOT use seat belt, and drive with extra care.



DETAILS	ORDER #
700/900 Series with SN 5500000 or higher	533396
Air-cooled 700 Series with SN 5499999 or lower	533397
Liquid-cooled 700/900 Series with SN 5499999 or lower	533399

## LIGHT KIT – BEACON STROBE

Installs on OPS or ROPS, adding a high degree of visibility with yellow strobe effect.

DETAILS	ORDER #
Beacon Strobe w/ Straight Stand	503326
Beacon Strobe w/ Offset Stand (For Aluminum Sunshade Canopy)	503341



## LIGHT KIT – LED WORK LIGHTS

Improves visibility while mowing.  
Standard on 700 and 900 Series models (except 725KT.)  
Plug-in ready for easy installation.

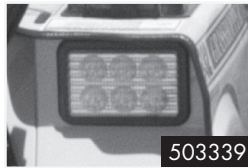

503339



503342

LED LIGHT KITS	ORDER #
All 500V Series, 600 Series (SN 5300000 and above), 700 Air-Cooled / 721 (SN 450000 through 7199999), 725D/729/900 Series (SN 450000 through 6819999)	503339
725KT (SN 7200000 and above)	503342

## Lever and Seat Kits

The Premium Comfort Seat – a standard feature on all Grasshopper FrontMount™ models – was designed with speed, control and comfort in mind. Maintaining a low center of gravity and positioned at the pivot point of zero-radius turning, it includes solid, stable, maintenance-free iso-suspension, shock-absorbing, coil-spring suspension, and variable density foam with padded armrests, backrest and lumbar support. CoolTemp™ Cordura® exterior repels moisture and remains cool to the touch even in the hot summer sun. **Armrests are reinforced with the structural strength of steel seat side panels to support the weight of the operator when mounting and dismounting from the machine.** ComfortReach™ control levers are hydraulically dampened and foam-padded for precise and effortless control with automatic return to neutral. With the instrument console positioned in natural reach and an extended footrest to provide additional leg room, Grasshopper's Premium Comfort Seat is integral to unmatched comfort and performance. Various options and accessories are available to accommodate the wide range of preferences that sometimes exist when multiple operators use the same Grasshopper. These include control lever, seat cushion and other options found on pages 9 – 11.



## LEVERS QUIKAJUST™ TILT CONTROL

Allows you to maintain all the advantages of the standard Premium Comfort Seat while accommodating the size differences of multiple operators. Provides 9 inches of infinitely variable adjustment to accommodate the comfortable reach of any operator.

DETAILS	ORDER #
600 Series	503704
500V & 700 Series without Hydraulic Lift	503705
Units with hydraulic switch in lever	503706



## FOOTREST RISER

Optional footrest riser for 700 and 900 Series models raises footrest 2 inches to provide increased comfort for smaller operators.



ORDER # 606378

## SOFT-TOUCH FOAM GRIP

Replace worn and/or torn foam grips with new foam grips. Order two to replace both grips.

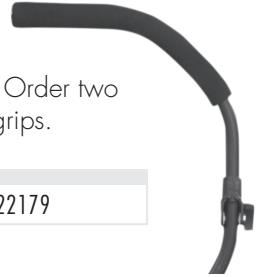

ORDER # 422179

## Hydra-Smooth™ Dampened, Dual-Steering Levers

MODEL	ComfortReach™ with 2-inch adjustment	QuikAjust Tilt™ with 9-inch adjustment	Ratchet-Eze™ with "no tools" adjustment for either ComfortReach™ or QuikAjust Tilt™ levers
500V Series FM	●	○	○
600 Series FM	●	○	○
700 Series FM		●	○
900 Series FM		●	○



● = Standard ○ = Option

## LEVERS

"Tall Boy" QuikAdjust™ Tilt Control Levers are designed for "big and tall" operators providing 2 additional inches of clearance. Recommended whenever a Grammer seat kit is installed on machine.

DETAILS	ORDER #
Tall Boy QuikAdjust Tilt™	503707
For hydraulic switch in the right Tall Boy QuikAdjust Tilt™ lever	503708

## LUMBAR SEAT KIT WITH EMBROIDERED LOGO



ORDER #
504186

Contains the plush, heat- and moisture-resistant CoolTemp™ Cordura®-wrapped seat and backrest cushion with lumbar support and embroidered Grasshopper logo. This kit can replace vinyl seats. Order Foldable Armrest Kit (shown below) separately if desired.

## WIDE SEAT CONVERSION KIT

Adds 2 inches of sitting room for larger operators or for those who carry cell phones on their belts. A seat belt extension is included in the kit. Available for all 700/900 Series models with SN 5500000 and above. For 500V, 700/900 Series models with SN 6000000 and above, kit includes foldable armrests.

DETAILS	ORDER #
SN 5500000 - 5999999	503927
SN 6000000 & above (includes foldable armrests)	503928

## SEATBELT EXTENSION KIT

For standard Cordura seat. Adds up to 8" of belt length. Replaces seat mount only (included with 503928 Wide Seat Conversion Kit).

ORDER # 324201
----------------

## FOLDABLE ARMREST KIT

Allows greater on/off accessibility. Kit includes backrest support and other hardware but reuses existing cushions. For 500V, 600, 700 and 900 Series. Armrests are reinforced with steel side panels to support the weight of the operator when getting on and off.

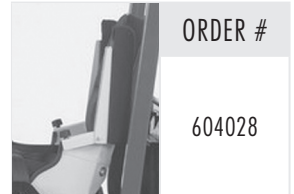

ORDER #
604028

## WEATHER COVER

Weather-resistant, black Cordura® fabric cover with embroidered Grasshopper logo keeps seat and engine area protected during storage or between mowings. Slips over ROPS, with Velcro closure to secure the opening.



ORDER #
420086

## PREMIER SUSPENSION SEAT – FULLY ADJUSTABLE

Provides maximum mowing comfort over rough ground. Seat can slide forward and backward and provides adjustable tension platform customized to operator weight to control ride quality. Also features adjustable armrests and lumbar tensions. Seat cushion and seat back are covered in durable Cool Temp™ Cordura® material. Premier kits are not available for 500V Series.



**NOTE:** Consider installing the taller “Tall Boy” lever option when installing Premier Suspension Seat, which sets higher than the standard Premium Comfort Seat.

DETAILS	ORDER #
<b>ORDER BOTH SEAT PAN KIT AND GRAMMER SEAT</b>	
Seat Pan for 600 Series	503666
Seat Pan for 700/900 Series	503667
Grammer Seat for 600/700/900 Series	503671

## SUNSHADE CANOPIES

Canopies are highly recommended for comfort and protection from the sun’s harmful rays. Vinyl version is lightweight, water-repellent and UV-resistant. Diamond-plated aluminum version tilts up and down and is highly resistant to abrasions. Vinyl and aluminum versions fit all models.

**Optional nine-inch diameter, one-speed fan** mounts to the bottom side of the aluminum canopy and adjusts up and down and fore and aft to direct maximum airflow on the operator.

**Optional LED Work Light Kit** (2-front, 1-rear) for the plug-in-ready aluminum canopy increases visibility for roadside mowing and in low light conditions. Lights tilt up and down. Rear light can also be set to flash for higher visibility when mowing.

See page 8 to order optional offset beacon light stand (**Order # 503341**) for aluminum canopy.



DETAILS	ORDER #
Vinyl Sunshade	533392
Aluminum Sunshade	503188
Fan Kit – Aluminum	503370
LED Light Kit – Aluminum	503371

# Deck MAXimizers™

## AIR DAM CONTROL KITS

Air Dam Kits can be installed to control dust and clippings from escaping the front edges of the mower deck in dry or dusty conditions.

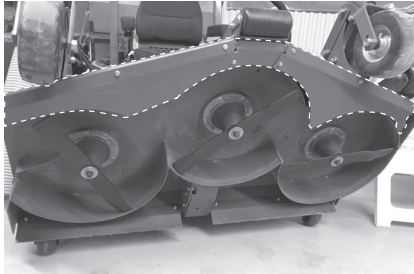

DECK MODEL	ORDER #
3242	503038
3344	503029
9544/SL9644	503019
3348	503030
9548/SL9648	503020
9552/SL9652	503021
3252/3452/3552/9852	503041
3461/3561/3661/3761/9861	503042
9561/SL9661	503022
3472/3572/9772	503043
9572	503014

## DECK FLOTATION BUSHINGS

Deck Flotation Bushings are located where the lift arms of the deck attach to the power unit. Both standard torsion action and full-flotation bushings are injection-molded for durability and allow the optimal degree of deck flotation for your mowing conditions. When gradual contours in the terrain lend themselves to lateral deck flotation, choose optional full-flotation bushings. Full-flotation bushings are distinguished by their "U" shaped indentation. Or, choose the standard torsion action bushings to keep deck cutting level over terrain even with small dips or rises. Bushings can be replaced in minutes so be sure to inspect them periodically and keep an extra pair on hand.

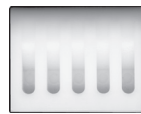

Standard  
Torsion-Action  
Bushing



Full Flotation  
Side-to-Side  
Flotation Bushing

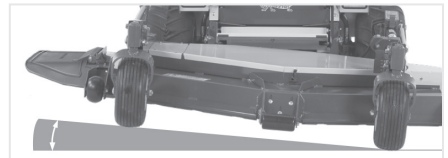

DETAILS	ORDER #
Order two (2) for standard torsion action bushings	282575
Order two (2) for full-flotation bushings (Not available for 500V Series)	282576

## EDGE-EZE™

For maintaining a clean, blade-cut edge along sidewalks, roadways and driveways, Edge-EZE™ completes the job much faster and with less effort than strenuous, hand-held edgers. A must for anyone wanting to save time maintaining lots of edges or who dislikes holding heavy, noisy edgers.

Ideal for commercial use, the reversible blade and hub assembly allow edging from the curb, sidewalk, driveway or turf. Downward pressure from electric actuator and placement of pivot point for the fork assembly keeps continuous contact between the blade and the hard surface. Choose the appropriate Edge-EZE™ model for mounting to side discharge or trim side of deck. For 48-inch and larger decks.

*When overgrowth is thick, first create a clean edge with a handheld power edger, then use the Edge-EZE in routine, scheduled maintenance for best performance.*



DETAILS	ORDER #
Electric Lift, Side Discharge decks only, RIGHT side	533137
Electric Lift, 35 & 37 Series Rear Discharge decks only, RIGHT side	533139
Electric Lift, Side Discharge or 35 & 37 Series RD decks, LEFT side	533142
Harness Adapter required with machines having Limited and/or Universal Wiring Harness	605860

## HIGH MOW KIT

Raises cutting height range by 3/4-inch for conditions that require a cutting height greater than 5 inches. Replaces standard fork housings on deck. Not available for 500V Series.

DETAILS	ORDER #
52- & 61-inch decks	503289
72-inch decks	503287

## HYDRAULIC LIFT KIT

Hydraulic Lift Kit for 700 Series and Model 937 raises front edge of decks up to 13 inches (11 inches on 72-in. decks) to clear curbs and maneuver over soft or uneven ground. (It does not adjust deck height.) Kits include Universal Wiring Harness, 50 lbs. counterweight and C-Wt. mount kit. A deck latch kit is required to add hydraulic lift on non-PowerFold® 33 and 34 Series decks. (Latch Kit order #503322).

### DETAILS

Dealer installation required if ordered as kit. Contact dealer for order numbers and installation requirements.



## POWERFOLD® HEIGHT ADJUSTMENT KIT WITH ELECTRIC DECK LIFT

For 3348 and 34 Series decks. Grasshopper's exclusive PowerFold® controls the cutting height and raises the mower deck upright for easy access under the deck – all with the ease of a toggle switch. The height adjustment function of the PowerFold® control box can be installed under the right armrest with optional Armrest Control Kit. Height can be set at 1/4-inch increments using optional metal spacer. Dealer-installed kits fit 3461 decks with SN 5441422 and above, and 3452 decks with SN 5441756 and above. Also available for 3348 decks with SN 5500000 and above. A Limited Universal Wiring Harness is required. (If tractor has a Universal or Limited Universal Wiring Harness which terminates under the seat instead of beside the brake lever, a wire extension (order #605958) will be required.



DETAILS	ORDER #
PowerFold® kit for 3452 & 3461 decks	504226
PowerFold® kit for 3348 deck	504227
Metal Spacer for 1/4-inch height adjust increments	766006
Limited Universal Wiring Harness	504784
Armrest Control (optional) for PowerFold®	503068
Mount Kit for Armrest Control on Premium Suspension (Grammer) Seat	503221
Extension Harness	605958

## SPLINE SHAFT PTO

Delivers more power more efficiently to the cutting deck or implement with more surface-to-surface contact while extending shaft longevity.



SHAFT	DECK	ORDER #
Sleeve and shaft	3472/3572/3661	605836 includes 398918 (sleeve) & 398527 (shaft)
Sleeve and shaft	3452/3552/3461/3561/3761	605835 includes 398917 (sleeve) & 398526 (shaft)

## ROLLER KITS

Anti-scalp kits are available for most decks. Listed here are the most popular anti-scalp roller kits. Make certain the kit you desire is available for your particular deck series and cutting width.

DETAILS	ORDER #
Front-Corners Roller Kit for 3344 & 3348 decks	503626
Left-Front Roller Kit for 500V52, 3452, 9852 & 9861 decks	503636

## SPEED-TRIMMING™ ROLLER KIT

A Grasshopper exclusive – with semi-pneumatic roller and vertical roller for 34, 35, 36, 37 and 98 Series decks is an innovative Grasshopper design that enhances trimability around trees and along fences, markers and foundations. Mounts to left front corner of the deck. Kit (503637) includes semi-pneumatic roller, vertical roller and mounting bracket.

In rear-discharge or mulching modes, it is also possible to mount a Speed-Trimming™ roller kit (503638) on the right front corner of 61- and 72-in. decks. Kit includes roller, vertical roller and mounting bracket.



DETAILS	ORDER #
Left hand corner of 52-, 61- and 72-in. decks	503637
Right hand corner of 61- and 72-in. rear-discharge decks	503638

## RETROFIT KITS FOR ATTACHING OLDER/NEWER DECKS TO NEWER/OLDER POWER UNITS

Economical kits allow new mower decks to be fitted on older power units and vice versa. A MaxTrax® Traction Kit (order #503885) will be required for 600 Series models prior to adding a new 33 Series deck. 600 and 700 Series models with SN 349999 and below will also require a Quik-D-Tatch® conversion kit in addition to one of the following adapter kits:

DETAILS	ORDER #
<b>New deck to pre-2003 power unit</b> which has single-piece rocker arms on the traction kit <b>AND</b> an implement other than mower deck; will also be attached to the power unit.	606680
<b>Note:</b> Decks equipped with the PowerFold® Lift may require the tractor to have a Universal Wire Harness installed.	504783
<b>New 600 Series power unit to pre-2003, non-Fold-Up™ deck</b>	604706
<b>New 700/900 Series power unit to pre-2003, non-Fold-Up™ deck</b>	604708
<b>Quik-D-Tatch® Conversion Kit for pre-1995 600 Series models</b>	503237
<b>Quik-D-Tatch® Conversion Kit for pre-1995 700 Series models</b>	503239

## DECK WHEEL OPTIONS

Michelin® X® Tweel® Airless Deck Wheels, for 72-inch decks only, performs like pneumatic tires, but without the inconvenience and downtime associate with flats. Tweel® deck wheels are not for use with PowerVac™ Collection Systems.



DETAILS	ORDER #
13x6.5x6 Tweel® Deck Wheels (72-inch decks only)	483867 (Order 2)





# GRASSMAX™

IT'S ALL ABOUT A PERFECT CUT!

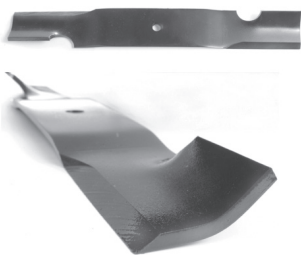
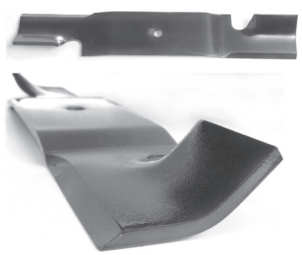

The only blade system incorporated into every MARBAIN® blades are exact replacements (High-Lift Notched) and a better-quality cut, minus thanks to a patented H twice as long in field important, make sure th

HIGH-LIFT NOTCHED	EXTREME HIGH-LIFT NOTCHED	MEDIUM LIFT																		
																				
<p>Recommended for most normal side-discharging applications, from the moist grass conditions of early spring to final mowing in the fall. Available with optional LaserEdge® EverSharp™ technology that requires no sharpening for the life of the blade.</p> <p><i>Not recommended for mulching or vacuum applications. Consider Medium Lift or Contour blades in dry, sandy soils.</i></p> <p>In dry, dusty conditions, ensure that deck is leveled properly and consider using air dams to minimize dust blow-out from around deck.</p>	<p>Extra-wide (3 in.) blades are recommended for side-discharge applications in very lush or overgrown conditions. They are recommended for use with liquid-cooled models or air-cooled models greater than 23 hp.</p> <p><i>Not recommended for mulching or vacuum applications and should never be used in dusty, sandy conditions.</i></p>	<p>Recommended for use with all PowerVac® Collection Systems. Medium Lift blades are required with certain mulching packages – use Medium Lift blades with any mulching package that originally included Medium Lift blades. Also recommended for most rear discharge decks.</p> <p><i>Also satisfactory for many side-discharge applications, including dry, sandy conditions.</i></p>																		
<p><b>Order Numbers:</b></p> <table border="0"> <tr> <td><b>Standard</b></td> <td><b>LaserEdge®</b></td> </tr> <tr> <td>15-in. – 320234</td> <td>N/A</td> </tr> <tr> <td>18-in. – 320239</td> <td>320317</td> </tr> <tr> <td>21-in. – 320245</td> <td>320318</td> </tr> <tr> <td>25-in. – 320253</td> <td>320319</td> </tr> </table>	<b>Standard</b>	<b>LaserEdge®</b>	15-in. – 320234	N/A	18-in. – 320239	320317	21-in. – 320245	320318	25-in. – 320253	320319	<p><b>Order Numbers:</b></p> <table border="0"> <tr> <td>15-in. – 320248</td> </tr> <tr> <td>18-in. – 320241</td> </tr> <tr> <td>21-in. – 320246</td> </tr> <tr> <td>25-in. – 320254</td> </tr> </table>	15-in. – 320248	18-in. – 320241	21-in. – 320246	25-in. – 320254	<p><b>Order Numbers:</b></p> <table border="0"> <tr> <td>15-in. – 320231</td> </tr> <tr> <td>18-in. – 320236</td> </tr> <tr> <td>21-in. – 320242</td> </tr> <tr> <td>25-in. – 320250</td> </tr> </table>	15-in. – 320231	18-in. – 320236	21-in. – 320242	25-in. – 320250
<b>Standard</b>	<b>LaserEdge®</b>																			
15-in. – 320234	N/A																			
18-in. – 320239	320317																			
21-in. – 320245	320318																			
25-in. – 320253	320319																			
15-in. – 320248																				
18-in. – 320241																				
21-in. – 320246																				
25-in. – 320254																				
15-in. – 320231																				
18-in. – 320236																				
21-in. – 320242																				
25-in. – 320250																				

## BLADE SIZE REQUIREMENTS FOR SIDE-DISCHARGE DECKS:

41-in. decks: two (2) 21-in.	42-in. and 44-in. decks: three (3) 15-in.
48-in. decks: one (1) 15-in. and two (2) 18-in.	52-in. decks: three (3) 18-in.
61-in. decks: three (3) 21-in.	72-in. decks: three (3) 25-in.





in the world manufactured to meet the precise design tolerances by Grasshopper DuraMax® deck. The cutting edge of GrassMax™ is proven to last longer compared to aftermarket blades claiming to last longer. GrassMax™ blades are 2.5 inches wide (3 inches on Extreme) and 1/4-inch-thick and through-hardened to hold their edge longer for minimal grass buildup and optimum airflow for side or rear discharge. The heat-treating process that makes them 25 to 40% harder and last longer than aftermarket options. If cut quality and long wear are important, the Grasshopper logo is stamped onto the blade.

## LOOK FOR THE LOGO

on the grass side of the blade to be sure you're using GrassMax™ blades.

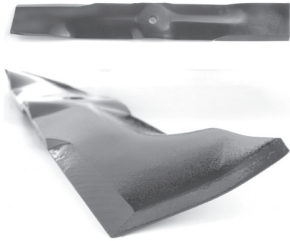
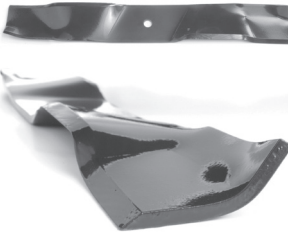

CONTOUR	HIGH-LOW MULCHING	SHREDDER™
		
<p>The blade of choice for the highest quality cut in side-discharge mode in ideal conditions where the 1/3 rule is followed. They are also preferred when mowing over dry, sandy soils. In high-profile areas that are mowed on a regular basis, Contour blades will leave the most manicured cut.</p> <p><i>Not recommended in lush, moist, high-volume conditions.</i></p>	<p>Designed for use with all mulching packages beginning with SN 5700000 and above. In conjunction with the Down Discharge™ mulching baffles, High-Low Mulching blades recut clippings multiple times thanks to an extended cutting edge and a carefully crafted rise and fall airflow pattern that helps clippings disappear into the turf canopy.</p> <p><i>Use Medium Lift blades if they were provided with your original package.</i></p>	<p>Looking for a toothy-edged blade to break apart leaves or clippings in drier conditions? The Shredder™ Blade was designed for this purpose. Used with Grasshopper 52-, 61- and 72-inch DuraMax® decks, Shredder™ blades are the best choice when serrated-wing blades are desired to reduce volume of leaves and clippings.</p> <p><i>Not for Down Discharge™ mulching but can reduce leaf and clipping volume in drier conditions.</i></p>
<p><b>Order Numbers:</b>            15-in. – 320233            18-in. – 320238            21-in. – 320244            25-in. – 320252</p>	<p><b>Order Numbers:</b>            15-in. – 320235            18-in. – 320240            21-in. – 320247            25-in. – 320255</p>	<p><b>Order Numbers:</b>            18-in. – 320321            21-in. – 320322            25-in. – 320323</p>

### BLADE SIZE REQUIREMENTS FOR 35R, 37R & 4XR REAR DISCHARGE SERIES DECKS:

3552R 52 in. decks: two (2) 18-in. – 320280 (CCW); one (1) 18-in. – 320236  
 3561R/3761R 61-in. decks: two (2) 21-in. – 320285 (CCW); one (1) 21-in. – 320242  
 3572R 72-in. decks: two (2) 25-in. – 320290 (CCW); one (1) 25-in. – 320253

M1 4XR 48 in. decks: two (2) 18-in. – 320236; one (1) 15-in. 320231; one (1) Grass Thrower - 766025

M1 4XR 52 in. decks: three (3) 18-in. – 320236; one (1) Grass Thrower – 766025

M1 4XR 61-in. decks: three (3) 21-in. 320242; one (1) 18-in. 320240

M1 4XR 72-in. decks: three (3) 25-in. 320250; one (1) 18-in. 320240

100V/200V-G4 4XR 48-in. decks: two (2) 18-in. 320236; one (1) 15-in. 320231; one (1) 766026 – Grass Thrower

100V/200V-G4 4XR 52-in. decks: three (3) 18-in. 320236; one (1) Grass Thrower – 766026

100V/200V-G4 4XR 61-in. decks: three (3) 21-in. 320242; two (2) 766025 – Grass Thrower; one (1) 766026 – Grass Thrower

## SIDE-DISCHARGE CONTROL KIT

Control the discharge of the mower to avoid putting clippings in flower beds and on sidewalks. When in the open position, the discharge is released from the side of the mower deck.

When in the closed position, the discharge is released from the rear of the mower deck.

(Does not replace Down Discharge Mulching Kit.)

MODEL	ORDER #
524V-42	504209
All Others	504210

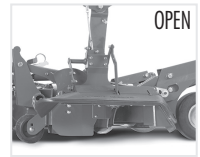

## MULCHING PACKAGES

Years of airflow research have led to a mulching package design that produces exceptional results in the Down Discharge™ mode. More than just a kit, the Grasshopper mulching package reroutes airflow and clippings into a vortical pattern that forces them deep into the turf after being recut into small particles.

Mulching packages consist of three main components: special shrouding, High-Low GrassMax™ blades and a discharge restriction plate. Only four bolts are required for easy field installation. Available for all deck series except 35 Series rear-discharge decks.

**NOTE:** While mulching packages for current production decks include High-Low style GrassMax™ blades, prior mulching packages (SN 5499999 and lower) included Medium Lift blades. Customers should continue to order whichever style of blade was furnished with their mulching packages. High-Low blades are not compatible with mulching packages designed for Medium Lift blades.

DECK MODEL	ORDER #
3242	504564
3344	504565
3348	504566
3252/3452	504567
3461/3661	504569
3472 / 9772 (SN 5500000 & above)	504571
9772 (SN 5499999 & below)	504572
9544 / SL9644	503589
9548 / SL9648	503591
9552 / SL9652	503593
9561 / SL9661	503595
SL9852	504568
SL9861	504560

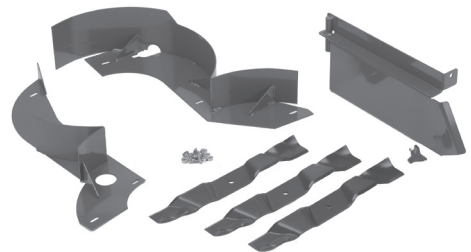

## MULCHING GUIDELINES

Grasshopper's highly engineered mulching package enables clippings to be recut into small pieces and discharged into the turf canopy where they decompose and nourish the lawn. Here are a few tips to ensure you get the best results from mulching:

## SPINDLE CONE AND FIBER WASHER

Spindle Cones shield spindle housing and seal lower bearings from moisture, fiber wrap and other material. Fiber Washers provide a buffer between spindle housing and cone.

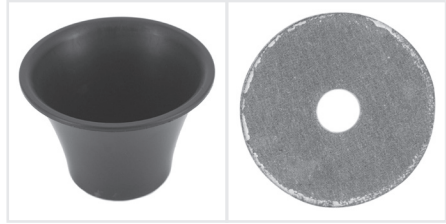

Spindle cone	423680
Fiber washer	421200

### 9 TIPS FOR BETTER MULCHING:

- 1 Follow the "1/3 Rule": Don't cut off more than one-third of the grass height when you mulch.
- 2 Keep mower blades sharp. Because grass clippings are recut several times in the Down Discharge™ mulching mode, mower blades may need to be sharpened more frequently.
- 3 Dry clippings mulch easier than wet ones. In moist conditions, clean the deck often to achieve best results and slow down.
- 4 Mow the grass about 1/2-inch higher than you would normally mow in the side-discharge or vacuum modes.
- 5 Grasshopper mulching packages are shipped with proper blades. Always use the recommended blades rather than aftermarket "mulching" brands.
- 6 Mow often. This will encourage a denser turf and will also help maintain grass at a desirable height for mulching.
- 7 Fertilize less if you follow a regular mulch program. Mulching returns nutrients back to the soil, reducing the need for chemical fertilizers.
- 8 Disengage the PTO drive before passing over sidewalks and drives to prevent clippings from discharging onto these areas.
- 9 The recommended minimum cutting height is 2-1/2". If the grass is too tall to follow the "1/3 Rule", you may need to make two passes over the grass for optimum results. Cut grass higher on the first pass, and on the second pass cut at the desired height in the opposite direction from the first pass.

A combination of side discharge, mulching and vacuum collection throughout the year contributes to a healthier lawn. Clippings will normally improve the vigor of a lawn by returning nutrients to and holding moisture content in the soil. Removing leaves and clippings in overgrown conditions with a PowerVac® Collection System will also contribute to the health and appearance of your lawn.

# Implement MAXimizers™

## AERA-VATOR™ ACCESSORIES

AERA-vator™ Cart will hold a 40-inch (Model 440) or 60-inch (Model 660) AERA-vator™. The cart, finished in Grasshopper brown with a logo on each end, makes moving the detached AERA-vator™ around the shop easier. Rotate the AERA-vator vertically on the cart for space-saving storage.

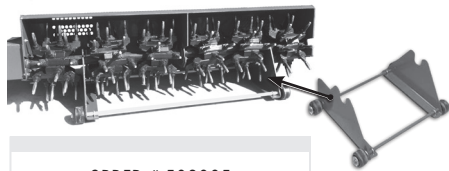

ORDER # 503005

## BROOMS & ACCESSORIES

**Fixed-angle Mount Kit** angles broom to the right. **Bidirectional Mount Kit plus joystick control** provides complete versatility for angling the broom right or left and raising or lowering broom. A Gauge Wheel Kit is also included with bidirectional mount.

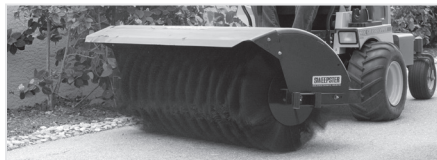

DETAILS	ORDER #
48" broom (600, 700 & 900 Series)	533420
60" broom (700 & 900 Series)	533425
Fixed mount kit (600, 700 & 900 Series)	503567
Bidirectional mount kit + joystick control (700 & 900 Series)	503562 + 504800
Bidirectional mount kit also requires a Limited Universal Wiring Harness (if one is not already installed on power unit)	504784

**Stand Kit** provides stable storage support for brooms that don't have gauge wheels installed.

ORDER # 503306

**Debris Deflectors** keep dust to a minimum. Not recommended when clearing wet snow.

DETAILS	ORDER #
48" SN 6070857 & above (square)	504228
48" SN 6070856 & below (rounded)	504230
60" SN 6070387 & above (square)	504229
60" SN 6070386 & below (rounded)	504231

**Gauge Wheel Kit** is optional with fixed-mount brooms and is highly recommended when the broom is used for dethatching. Adjustment spacers allow desired pressure on surface while casters facilitate turns.

ORDER # 503282

**Jack & Mount Kit** facilitates installation, storage and removal of the rotary brooms.

DETAILS	ORDER #
Fixed mount brooms	503303
Bidirectional brooms (SN 6271099 & below)	503304

# WINTER CAB ENCLOSURE AND ACCESSORIES

**Fully enclosed metal cab** for 700 and 900 Series is designed to protect the operator from winter elements. Cab is fully compatible with the use of all joystick-controlled snow implements. Electric windshield wiper and LED lights are standard on 533407. Winter cab enclosure is not for mowing or turf care applications.



POWER UNIT	ORDER #
SN 6060000 & above	533407

POWER UNIT	ORDER #
SN 5500000 to 6059999	533403

 May require counterweight. See counterweight requirements chart on page 31.

The following front panel kits are available for non-joystick-controlled implements:

DETAILS	ORDER #
Used with fixed-angle rotary brooms	503601
Used with manual dozer blades	503602
Used with joystick-controlled implements on power units equipped with 533405 enclosure. (Standard on 533407 cab)	503603
Used with manual-spout snowthrowers, Pro & PowerBlade™ hydraulic dozer blades and bidirectional broom.	503604

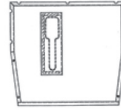

503601

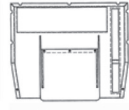

503602



503603

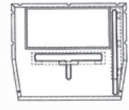

503604

**LED Light Kit** – Front and back for 533405 enclosures is longer-lasting and more energy efficient. (Standard on 533406 and 533507 cabs)

ORDER # 503328
----------------

**Beacon Light** for 533407 and 533406 cabs or 533405 enclosure.

ORDER # 503327 (SN 6060000 & above)
-------------------------------------

**Floor Heater Kit** for liquid-cooled models. Keep your feet warm as you clear snow on liquid-cooled 700 and 900 Series power units equipped with enclosure and optional heater.

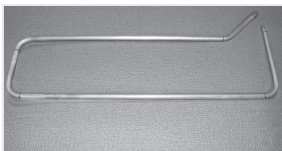
	ORDER #
	503271

**Heater Kit** for liquid-cooled models. Stay comfortably warm in the seat while your Grasshopper mows through snow.

DETAILS	ORDER #
533407 & 533406 cabs or 533405 enclosure	503270
533403 enclosures	503268

## Windshield Wiper Kit

replaces the cab enclosure's manual wiper control with an electric version. Standard on 533407 & 533406 cabs.



(The two-arm Pantograph wiper clears more windshield area.)

CAB/ ENCLOSURE	SINGLE ARM	PANTOGRAPH (TWO ARM)
533407	Standard	503952
533406	Standard	503952
533405	503951	503952
533403	503950	NA

## DOZER BLADE ACCESSORIES

**Cart for Blades and Snowthrower** is an option for dozer blade and snowthrowers that assists in installation, removal and storage.

	<b>ORDER #</b>
	503273

**Foot-Controlled Angling Kit** provides foot pedal control and allows operator to remain in the seat while quickly angling blade left to right.

<b>DETAILS</b>	<b>ORDER #</b>
48" & 60" manual control models	504232

## SNOWTHROWER ACCESSORIES

**Electric Lift Kit for Models 412 (except 412V) and 512 Snowthrowers** is the easy way to raise and lower snowthrowers with fingertip control.

<b>DETAILS</b>	<b>ORDER #</b>
600 Series	503338
700/900 Series	503329
Electric lift requires universal wiring harness if not already installed on machine (for SN 5900000 and above).	504784

**Snow Performance Package for 412 (except 412V) and 512 Snowthrowers** includes electric lift plus an electric spout rotation kit. Both controlled with a joystick (also included) mounted on steering lever. A convenient way to order the electric lift and spout rotation kits as a package deal and save!

<b>DETAILS</b>	<b>ORDER #</b>
600 Series	503646
700/900 Series	503647
Model 412 with SN 6073429 & above and Model 512 with SN 6073508 & above. <small>Contact Grasshopper Service Department for prior model years.</small>	

**Spout Rotation Kit - Electric** allows fingertip control to point the spout in any direction you wish snow to fly!

<b>DETAILS</b>
Model 412 with SN 6073429 & above and Model 512 with SN 6073508 & above. Requires 605858 Universal Y Adaptor if unit has electric lift previously installed.*

<b>ORDER #</b> 503645

\*Contact Grasshopper Service Department for prior model years.

**Tire Chains** for 20" or smaller turf-style drive tires provide extra grip on icy surfaces. Includes wheel spacers and longer lug bolts.

	<b>ORDER #</b>
	504745

## TURBINE BLOWER ACCESSORY

**Rocker Arm/Traction Kit Extension** Use with turbine blower to enhance traction by positioning weight of blower over the drive wheels of the power unit.

<b>ORDER #</b>
604708

# PowerVac™ MAXimizers™

## OPEN & XPEL™ KIT

Debris Xpel™ Arms inside the 15B hopper facilitate fast, efficient emptying. Optional for fixed-mount 15B PowerVac™ only (standard with HighLift™ 15B kit).

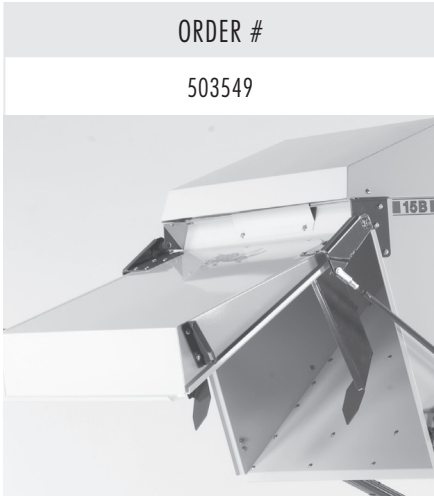

## DOLLY KITS FOR 15B COLLECTORS

Simplifies storage and handling of the 15B hoppers. Available for fixed-mount or HighLift™ collectors.

DETAILS	ORDER #
Fixed-Mount 15B	503195
HighLift™ 15B	503272



HighLift™ Dolly

## FABRIC AIR DEFLECTORS

Direct dusty airflow downward and away from operator, especially useful in dry conditions.

DETAILS	ORDER #
Model 8	503010
Model 15	503011
Model 25	503012



Fixed-Mount Dolly



## EXTEND THE LIFE OF YOUR VAC!

Vac Housing Liner Kit reduces wear in sandy or gritty conditions. Fits all vac housings.

ORDER # 606900

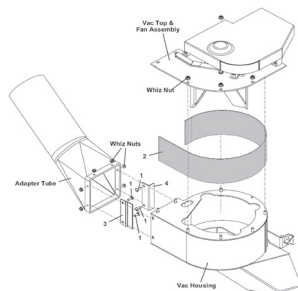

## COMPONENTS OF A POWERVAC™ COLLECTION SYSTEM

### Collector

Versions include Models 8F, 8HT, 12F, 12HT, 15B, HighLift™ 15B & 25. Models 15B and 16FM provide a choice of power actuator or hand lever for emptying.

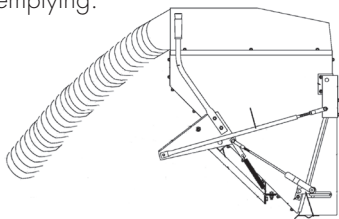

A standard length hose is included with all collectors. However, an extended length hose must be ordered separately with certain mower-deck combinations. A hose sized to the proper length is crucial to performance.

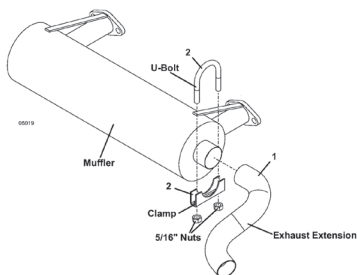

### Exhaust Deflector

Certain combinations require exhaust extension or deflection.

### Air Dam Control Kit

Adding an Air Dam Kit minimizes dust and leaves from escaping the front of the deck and provides a cleaner environment for the operator. See page 12.

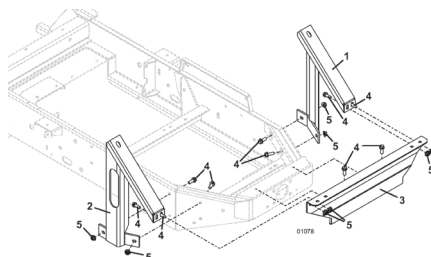

### Mount Kit

Collector mount kits are specific to the power unit and to the collector. Choose HighLift™ 15B for emptying into elevated spaces.

### Vac Drive Kit

Vac drives are specific to the size of deck and deck series.

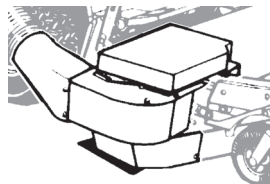

### Medium Lift Blades

Medium Lift blades are required with PowerVac™ Systems. Be sure to install Medium lift blades when switching from side discharge or mulching to vacuum applications.





# TIRES & STEERING: TRACTION & TURNING

Turf damage should not be a common experience on a Grasshopper. A little practice on proper turning will make for “an ounce of prevention” while choosing the right tires and inflating them to the proper level will provide for “a pound of cure.”

Grasshopper power units have advanced handling characteristics unlike any other mower. For example, gas-cylinder dampers on the steering controls protect against operator over-aggressiveness on the drive system. Low pressure tires flex with the terrain, providing an extra grip for traction. A low center of gravity allows for a smoother ride and better ground-hugging properties. Internal components of the drive system are design-matched for smoother responsiveness in forward and reverse.

**The two most common causes of turf scuffing are tires slipping and pivoting on a tire when making turns.** Fortunately, both situations can be avoided. To prevent tire slippage, use only a low pressure gauge to ensure tires are inflated exactly as indicated on the rims. A common misconception is that bar tread tires create more turf damage. Bar tread tires require less air pressure than most standard turf tires, thus they float and flex with the terrain to hug the ground well without spinning out. If you frequently mow over soft soils or on undulating terrain, consider the switch to low pressure, bar tread tires for a more turf-friendly experience.

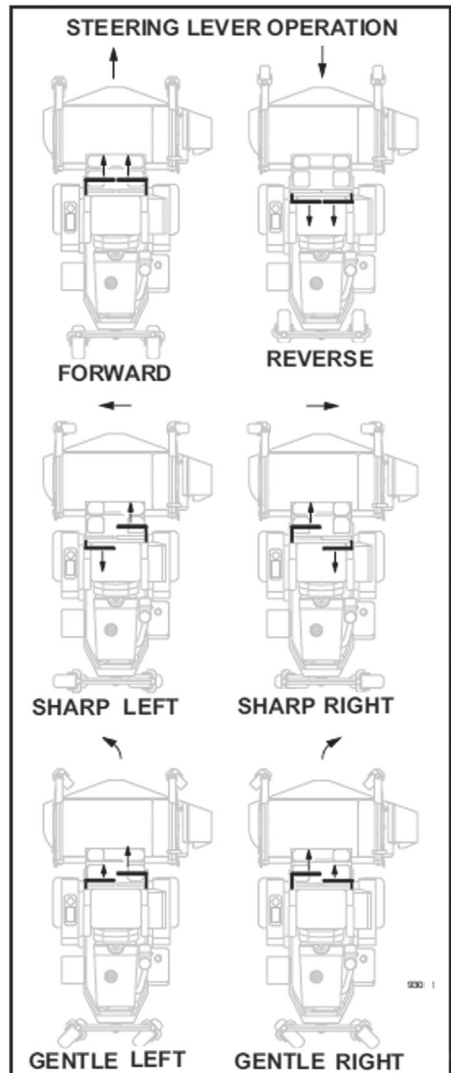

To prevent turf scuffing caused by pivoting on a tire during turns, remember that both drive tires should be rotating when making a turn. Avoid letting go of one lever when making a turn. For gradual turns, keep both tires rotating forward, applying extra force to whichever lever controls the outside tire of the turn. For sharp, zero-radius turns, make sure to counter-rotate the drive tires. This is done by pulling back on one lever while pushing forward on the other. As long as both tires are rotating, the mower will leave no divots on the pivots.

Beginning a sharp turn from a stationary position can cause caster wheels to bind. To ensure that caster wheels leave no marks on the lawn, keep the unit moving in forward or reverse while turning left or right to allow the casters to turn freely.

The advanced components in your Grasshopper are intended to provide you every advantage in creating a beautiful lawn. By spending a little practice time on turns in an open area, and by keeping tires properly inflated, turf damage should be eliminated.

**Please note that proper tire pressure affects traction, riding comfort and quality of cut.  
ALWAYS REFER TO DECALS ON TIRE RIMS FOR PROPER AIR PRESSURE.**

In addition to its effect on deck pitch and cutting quality, proper tire pressure is critical where traction is concerned. Over-inflated drive tires will cause poor traction resulting in slippage and possible turf damage. Correct tire inflation also extends tire life, reduces wear and tear to frame of machine, and improves the comfort of the ride.

## TIRE OPTIONS FOR YOUR FRONTMOUNT™ MOWER //////////

Optional tire styles are available for many Grasshopper models. Four-ply turf-type tires provide good overall traction suited for level terrain. Low Pressure (LP), high flotation tires (also known as bar tread, tractor-type or chevron-type) flex with the terrain for maximum traction, thus minimizing the scuffing caused by wheel spin-out. Michelin® X® Tweel® airless tires eliminate flat tires.



### Bar Tread Design

Standard on 700 and 900 Series. Low pressure, high flotation with extra grip tread providing excellent traction. Optional on 500V & 600 Series.



### Turf Tread Design

Standard on 500V and 600 Series. Optional on 700 and 900 Series. Overall excellent performance on level mowing areas.



### Airless Turf Tread Design\*

Michelin® X® Tweel® airless turf tread drive tires perform without the inconvenience and downtime associated with flat tires. Optional for 600, 700 and 900 Series.

\* Tweel® turf drive tires are not for use with PowerVac™ Collection Systems.

When replacing tires on your Grasshopper, demand Grasshopper OEM replacement tires. Aftermarket tires come in all sizes, textures and qualities despite their claims to be exact replacements. Having tires of unequal size or handling capabilities can result in loss of comfort, difficult handling and poor cutting quality. Non-OEM aftermarket tires may not hold well on rims. Grasshopper parts technicians will take the extra care and attention to closely match your new set of drive tires.

FRONTMOUNT™ DRIVE TIRE OPTIONS – FIELD INSTALLED	ORDER #
Bar Tread Tire & Wheel Set (20 x 8-10) for 500V Series	504244
Bar Tread Tire & Wheel Set (21 x 11-8) for Model 620T & 623T	604806
Turf Tire & Wheel Set (20 x 10-8) for Model 620T & 623T	504752
Turf Tire & Wheel Set (20 x 10-10) for T/T6 & 900 Series models (For use with tire chains)	504240
Turf Tire & Wheel Set (22 x 11-10) for T/T6 & 900 Series models SN 6799999 and below (Cannot be used with tire chains)	604816
Turf Tire & Wheel Set (24 x 12-12) for 900 Series model SN 6800000 and above (Cannot be used with tire chains)	483965 (Order 2)
Michelin® X® Tweel® Airless Turf Tread Wheel Set (22 x 11-12) for 700 Series models. (Also for 600 Series with 3552 rear discharge deck only) (Cannot be used with tire chains) Not for use with PowerVac™ Collection Systems.	483973 (Order 2)
Michelin® X® Tweel® Airless Turf Tread Wheel Set (24 x 12-12) for 900 Series models (Cannot be used with tire chains) Not for use with PowerVac™ Collection Systems.	483975 (Order 2)

## TAIL WHEEL OPTIONS

Models 524V-42 and 623T are equipped with a standard single fork tail wheel.

At least two tail wheels are required with all PowerVac™ Collection Systems.

Wide-stance single-fork tail wheels are standard on all other models. An advantage of two (or four) tail wheels is greater weight distribution, increased flotation, improved stability and castering effect. Visit with your Grasshopper dealer about tail wheel options for your Grasshopper.

**Single-Fork  
Tail Wheel**

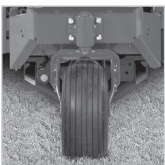

**Wide-Stance Single-Fork  
Tail Wheel**



**Dual-Fork  
Tail Wheel**



**Wide-Stance Dual-Fork  
Tail Wheel**



**Flat-Proof Tail Wheel** (13 x 6.5-6) is a semi-pneumatic assembly which won't go flat and requires no air. Can replace standard tail wheels. Assembly includes dust-proof bearings. Using Grasshopper Tire Sealant in standard pneumatic tire is another flat-proof option.

DETAILS	ORDER #
Flat-Proof Tail Wheel	603976
Order two (2) spacers when installing on 500V and 600 Series (SN 6599999 & lower)	902422

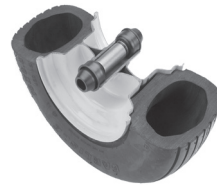

**Michelin® X® Tweel®** (13 x 6.5-6) Airless Tail Wheel (set of 2) performs without the inconvenience and downtime associated with flats. Also available for 72-inch deck wheels.

Tweel® airless tail and deck wheels are not for use with PowerVac™ Collection Systems.

	<b>ORDER #</b>  483867 (Order 2)
---	---

Keep Your Grasshopper Busy Year-Round With These Timesaving Implements!



AERA-varator™ Aeration



Little Bully™ Dozer Blades



DriftBuster™ Snowthrowers



Cleansweep™ Rotary Brooms



Prolawn Shielded Sprayers



Zero-Turn Turbine Blower

MAXIMIZER™ MAINTENANCE TIPS

1. Sharp mower blades produce a clean cut, keep grass healthy, and reduce fuel consumption.
2. Check spring tension idler settings on deck periodically. Proper belt tension extends belt life, ensures optimum power delivery and proper blade tip speed for the best cut.
3. Check tire inflation daily. Don't overinflate tires. The low pressures specified for your Grasshopper will help ensure Grasshopper's legendary comfortable ride and reduce wear and tear on the power unit.

# GRASSHOPPER PREMIUM HEAVY-DUTY TIRE SEALANT

Proper tire inflation improves quality of cut. While helping maintain constant air pressure, Grasshopper Tire Sealant stops flats, saves fuel and extends tire life – keeping your equipment moving on schedule.

- Twin-Fiber Sealant contains three times the fiber content of other brands, and is backed by more than 25 years of market testing.
- Eliminates flat tires from tread punctures, bead leaks, rim leaks, and other forms of air loss for the life of a tire.
- Adheres to inside of the tire and rim to provide permanent, full-time protection against tread punctures, bead leaks, rim leaks and other forms of air loss.
- pH balanced to prevent rubber corrosion and contains rust inhibitors to protect rims.
- Effective in temperature extremes from -40° F to 200° F.
- Excellent shelf life allows customers and dealers to keep plenty in stock without fear of spoilage.
- Protects against punctures up to 1/4" in the tread area. Coats all inside surface areas and seeks location of air loss.

## HOW IT WORKS

1. Liquid-absorbing cellulose fibers immediately fill the hole with their organic bulk. As organic fibers and particulate liquid slow the air from escaping, synthetic nylon fibers cover the hole and create a flexible seal on the inside of the tire.
2. Finally, the hole becomes packed with flexible fiber solids – creating a permanent, flexible seal.
3. When the puncturing object is removed, centripetal force further packs the particulate material into the hole to seal off the puncture. Very small amount of air escapes during fast process.



Grasshopper Tire Sealant 32 oz. bottle will treat one turf tire drive wheel, or two tail wheels on FrontMount™ unit, or two front wheels on MidMount™ unit. Bar Tread tires require 1.5 bottles each. If you own multiple mowers, consider ordering Grasshopper Tire Sealant - 5-gallon bucket.

DETAILS	ORDER #
32 oz. bottle	345020
5-gallon bucket	345015
Reusable pump for 5-gallon bucket	141610

# OEM PARTS PROTECTING YOUR INVESTMENT



Don't cut corners on quality. When you invest in quality Grasshopper equipment, don't be tempted to save a few dollars on generic aftermarket parts that can reduce your mower's power or efficiency. Protect your investment and ensure peak performance by trusting only genuine Grasshopper parts and supplies to maintain your mower. Aftermarket parts have proven time and time again to be unacceptable, even voiding warranties in some situations. Manufactured to meet ultra-precise engineering specifications, genuine Grasshopper parts help you maximize performance and significantly extend the life of your mower.

## The following is a case in point: aftermarket oil filters that don't make the grade.

The cross section of a hair is on average about 70 microns in diameter and hardly visible to the human eye. A white blood cell is only 25 microns wide and is invisible to the unaided eye. Yet, particles much smaller than this are capable of contaminating and shortening the life of a drive system, and many filters allow such particles to recirculate. In drive systems, these particles are abrasive to valves and other moving components.

A micron is .001 mm or .00003937 inches. While most small engine oil filters use up to a 40-micron filter, transmissions work under close tolerances, heavy stress loads and higher temperatures and thus require more effective filtration.

Most zero-turn mowers use a 10- to 25-micron rated filter. Most of these are nominal filters meaning that as fluid passes through them, they only trap about half of the particles of the stated size. Grasshopper mowers, on the other hand, use finer particle filtration systems to ensure a longer service life from its drive systems. Superior filtration is one reason Grasshopper drive systems last longer and require fewer fluid changes. Superior filtration and superior transmission fluid combine to provide the lowest operating costs of any commercial drive system available.



If this were  
a cross section  
of a hair ...

This is how a  
white blood cell  
would compare

And this is how a  
7-micron particle would  
compare with the hair  
and the blood cell

## COOLTEMP HYDRO-MAX™ FLUID

CoolTemp Hydro-Max™ fluid paired with genuine Grasshopper filters form an advanced protective shield that eliminates the need for break-in fluid changes and significantly extends fluid and filter service intervals, saving time and money.

DETAILS	ORDER #
1 qt.	345044
2 gal.	345046



# COUNTERWEIGHT REQUIREMENTS FRONTMOUNT™ POWER UNITS



Counterweight **NOT** required on FrontMount™ models equipped with PowerVac™ Collection System.

600 SERIES (with OPS)	SINGLE TAIL WHEEL	2 OR 4 TAIL WHEELS
48" Dozer Blade	50 lbs.	50 lbs.
48" Snowthrower	50 lbs.	50 lbs.
48" Rotary Broom - Fixed Mount	NA	100 lbs.
40" AERA-vator™ (Model 623T)	NA	100 lbs.

With collection system in place on 600 Series, counterweight is removed. Counterweight is replaced when collection system is removed.

700 SERIES (with ROPS) Mower Deck Model	SINGLE TAIL WHEEL W/O GRASS COLLECTOR		2 OR 4 TAIL WHEELS W/O GRASS COLLECTOR	
		With Enclosure*		With Enclosure*
3348	0 lbs.	NA	0 lbs.	NA
3452 / 3452PF / 3452RPF / 3552RPF	0 lbs.	NA	0 lbs.	NA
3461 / 3461PF / 3461RPF / 3561RPF / 3661PF	50 lbs.	NA	50 lbs. (2 cyl. models only)	NA
3472PF / 3472RPF / 3572RPF		NA	100 lbs.	NA

Hydraulic Deck Lift Kit on 700 Series includes 50 lb counterweight and mount kit. Requires additional 100 lb (total of 150 lb) counterweight with 72" deck.

Implements		With Enclosure*		With Enclosure*
AERA-vator™ 40"	50 lbs.	NA	50 lbs.	NA
AERA-vator™ 60"	NA	NA	100 lbs.	NA
Rotary Broom: Bidirectional	NA	NA	100 lbs.	150 lbs.
Rotary Broom: Fixed Angle	50 lbs.	NA	50 lbs.	150 lbs.
Dozer Blade, 48" & 60"	50 lbs.	NA	50 lbs.	150 lbs.
Snowthrower, 48"	50 lbs.	NA	50 lbs.	150 lbs.
Snowthrower, 60"	NA	NA	100 lbs.	150 lbs.

Single tail wheel with 100 lbs. or more counterweight not recommended. A dual-tail wheel option is required for 60" AERA-vators™, 48" or 60" bidirectional brooms, 60" snowthrowers and/or winter enclosures for 700 Series air-cooled models.

900 SERIES (with ROPS) Deck or Implement	Liquid-Cooled† W/O Enclosure*	Liquid-Cooled† With Enclosure*	Air-Cooled†† W/O Enclosure*	Air-Cooled†† With Enclosure*
3452 / 3452PF / 3452RPF / 3552RPF	0 lbs.	NA	NA	NA
3461 / 3461PF / 3461RPF / 3561RPF	0 lbs.	NA	NA	NA
3472PF / 3472RPF / 3572RPF	50 lbs.	NA	50 lbs.	NA
3661PF / 3761RPF	0 lbs.	NA	0 lbs.	NA
AERA-vator™ 40"	0 lbs.	NA	0 lbs.	NA
AERA-vator™ 60"	100 lbs.	NA	100 lbs.	NA
Rotary Broom - Bidirectional, 48" & 60"	50 lbs.	150 lbs.	50 lbs.	100 lbs.
Rotary Broom - Fixed, 48" & 60"	50 lbs.	150 lbs.	0 lbs.	100 lbs.
Dozer Blade, 48"	0 lbs.	150 lbs.	0 lbs.	100 lbs.
Dozer Blade, 60"	50 lbs.	150 lbs.	50 lbs.	100 lbs.
Snowthrower, 48"	50 lbs.	150 lbs.	50 lbs.	100 lbs.
Snowthrower, 60"	100 lbs.	150 lbs.	100 lbs.	100 lbs.

\*Winter Enclosure is not for mowing or turf care applications.

† When ordering counterweight for 900 Series liquid-cooled models, a counterweight mount kit is required.

†† The air-cooled 937 is equipped with the Weight Mount kit and one 50 lb. weight. If the Optional Hydraulic Lift is installed, additional weight is NOT required. The weight chart above for the 937 shows ADDITIONAL weight required for different implements.

# MAXIMIZER™ OPTIONS INFORMATION

Part of the Grasshopper advantage is being able to tailor your Grasshopper to fit your exact range of mowing conditions. Options, accessories and kits are available to maximize performance and are referred to as MAXimizers™. Many of the most popular MAXimizers™ for present and past models are listed in this guide, where a brief overview of power unit, deck, vacuum collection system and implement options is provided. Complete instructions and information sheets are available for most options.

BEFORE CALLING YOUR DEALER TO ASK ABOUT MAXIMIZERS™, IT HELPS TO HAVE YOUR ORDER NUMBERS HANDY.

Model and serial identification numbers are affixed to all power units, decks and implements. Whenever calling with questions about options, it's necessary to provide both the model and serial number so that your dealer can provide you with accurate information. The serial number plate is typically found on the frame beneath the seat on power units and along the rear exterior of mower decks.

All kits must be ordered through authorized Grasshopper dealerships, and dealer installation is recommended for all kits.



Committed to the Cut.®

The Grasshopper Company • 105 Old U.S. Highway 81  
P.O. Box 637 • Moundridge, KS • 67107 U.S.A.

T: **620-345-8621** • [grasshoppermower.com](http://grasshoppermower.com)